

# MIRASOL PARCEL TWO

PART OF GOLF DIGEST P.C.D.,  
SECTION 4, TOWNSHIP 42 SOUTH, RANGE 42 EAST,  
CITY OF PALM BEACH GARDENS,  
PALM BEACH COUNTY, FLORIDA  
NOVEMBER, 2000 SHEET 3 OF 4

22

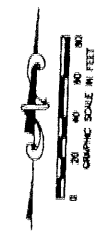

STATE OF FLORIDA  
COUNTY OF PALM BEACH  
THIS PLAT WAS FILED FOR  
RECORD \_\_\_\_\_ DAY OF \_\_\_\_\_  
AD, 2000 AND DULY RECORDED  
IN PLAT BOOK \_\_\_\_\_ ON PAGES  
\_\_\_\_\_ AND \_\_\_\_\_  
DOROTHY H. WILKEN, CLERK  
BY: \_\_\_\_\_

CIRCUIT COURT SEAL

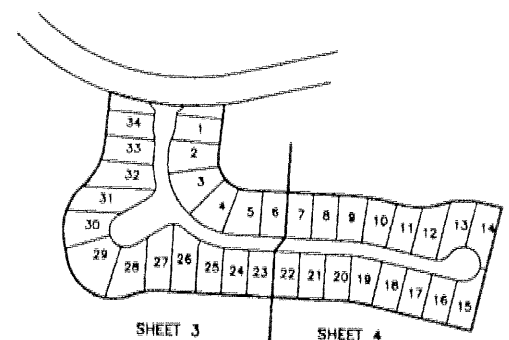

SHEET 3 SHEET 4  
**SHEET LOCATION MAP**  
(NOT TO SCALE)

- LEGEND**
- Δ CENTRAL (DELTA) ANGLE
  - CH CHORD
  - DE DRAINAGE EASEMENT
  - IEE INGRESS-EGRESS EASEMENT
  - L ARC LENGTH
  - NPBCID NORTHERN PALM BEACH COUNTY IMPROVEMENT DISTRICT
  - (NR) NON-RADIAL
  - ORB OFFICIAL RECORD BOOK
  - PAE PEDESTRIAN ACCESS EASEMENT
  - PB PLAT BOOK
  - PG(S) PAGE(S)
  - PCD PLANNED COMMUNITY DEVELOPMENT
  - R RADIUS
  - (TYP) TYPICAL
  - UE UTILITY EASEMENT
  - PERMANENT REFERENCE MONUMENT
  - FOUND LB 048
  - PERMANENT REFERENCE MONUMENT
  - SET LB 048
  - PERMANENT CONTROL POINT
  - SET LB 048
  - c CENTERLINE

THIS INSTRUMENT WAS PREPARED BY MARY HANNA CLODFELTER, P.S.M. IN THE OFFICES OF MOCK, ROOS & ASSOCIATES, INC., 5720 CORPORATE WAY, WEST PALM BEACH, FLORIDA 33407.

REV. 11-30-00  
CAD FILE:  
TATLPAZ02.PLOT

SCALE:  
1"=40'  
P.A. NO.:  
99313.00  
DATE:  
MARCH 2000  
DRAWING NO.:  
42-42-04-36

FLORIDA L.B. NO. 48  
**MOCK ROOS**  
ENGINEERS PLANNERS  
5720 Corporate Way, West Palm Beach, Florida 33407  
(561) 663-3113, fax 478-7248

SHEET 3 OF 4  
**MIRASOL PARCEL TWO**  
PART OF GOLF DIGEST P.C.D.,  
SITUATE IN SECTION 4,  
TOWNSHIP 42 SOUTH, RANGE 42 EAST,  
CITY OF PALM BEACH GARDENS,  
PALM BEACH COUNTY, FLORIDA